



#### GUEST SERVICES

- High-speed wireless Internet access throughout the entire Resort including all guest rooms and outdoor pool area.
- Non-smoking throughout the Resort including guest-room balconies, outdoor pool area, Lawn and Lakeside Terrace. Smoking is permitted outdoors in the parking lot and on the pathway along Lake Arrowhead.

Ming Hsieh Institute  
 Department of Electrical Engineering  
 Viterbi School of Engineering  
 PHE 606  
 3737 Watt Way  
 Los Angeles, CA 90089-0271  
 213-740-2694  
 mhi.usc.edu

Ming Hsieh Institute Leadership Team  
 Shri Narayanan, Director  
 Hossein Hashemi, Co-Director  
 Bhaskar Krishnamachari, Co-Director  
 Danielle Hamra, Business Officer

2011 Ph.D. Scholars  
 Firooz Aflatouni  
 Prasanta Kumar Ghosh  
 Samir Sharma  
 Chuan Wang  
 Omer Faruk Yilmaz

#### SPA OF THE PINES

Phone (909)744-3000 to schedule any services

•Spa of the Pines, a full-service luxury spa with nine treatment rooms, plus VIP Couples Journey Suite, retail boutique, fitness studio complete with the latest cardiovascular equipment, exercise studio for yoga, aerobics, and Pilates, beauty salon for hair and nails, three private lounges with an outdoor patio overlooking Lake Arrowhead, and two complete locker rooms each with steam room and experience shower.

•Daily use of fitness facility is complimentary to all guests (18 and older) and includes aerobic and yoga classes (daily schedule available at front desk), private locker room, Jacuzzi and steam room.

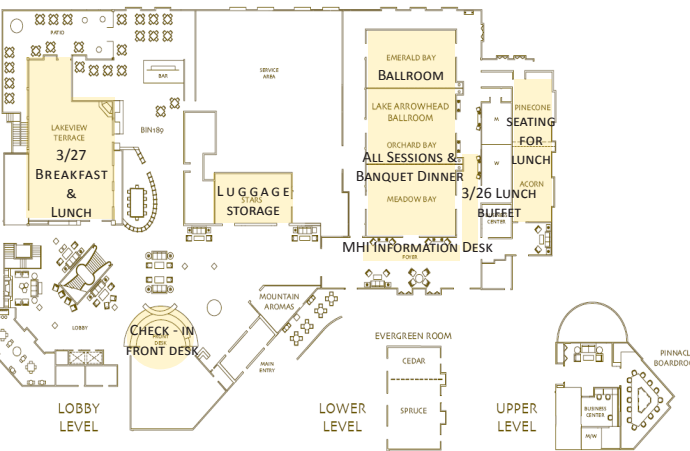

### The Ming Hsieh Institute Vision

To shape the future of the field of Electrical Engineering, enhancing its positive impact on all spheres of human endeavor, with emphasis on empowerment through intelligent technologies.

To foster creativity and invention within all facets of USC's Ming Hsieh Department of Electrical Engineering including research and education.

To create a vibrant intellectual environment at USC where world-class researchers in Electrical Engineering and related fields engage in the development of new ideas, thus positioning the Ming Hsieh Department at the forefront in thought leadership in the world.

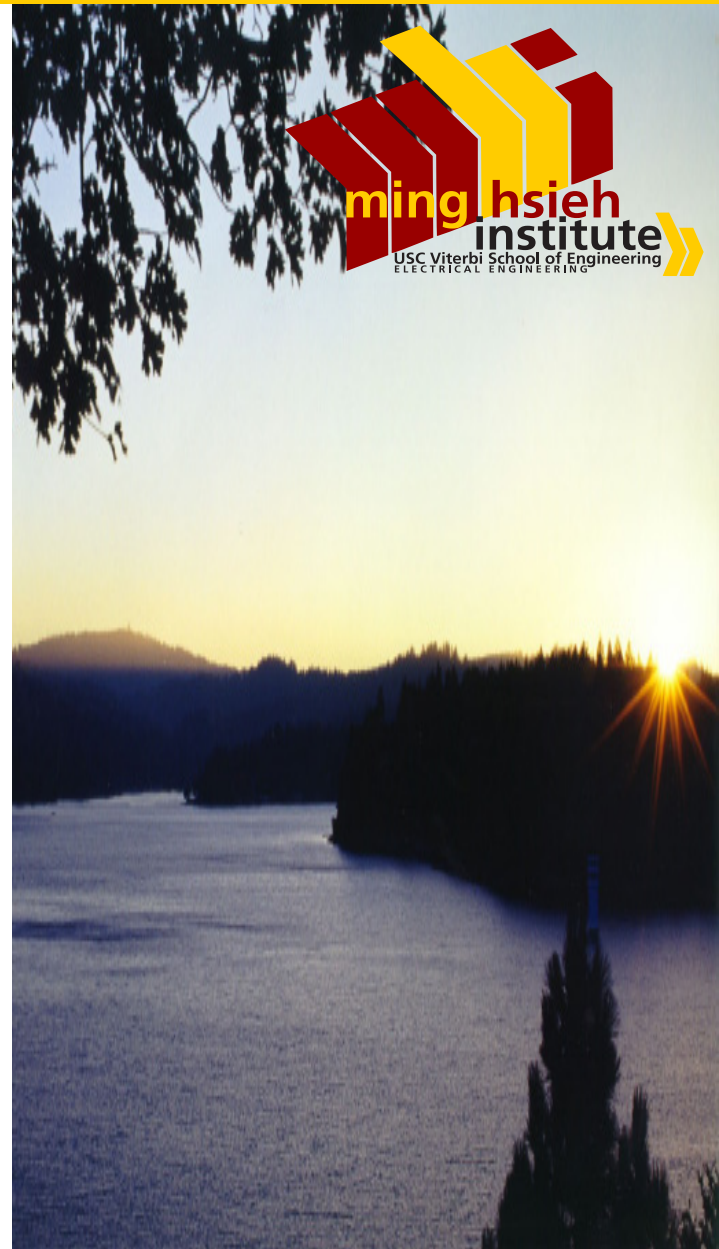

Resort locations reserved for EE Retreat - Acorn, Ballroom, Foyer, Lakeview Terrace and Stars (luggage room). Hotel staff has a copy of the Retreat agenda and can assist with directions at anytime.



Lake Arrowhead Resort and Spa

Address: 27984 Hwy 189

Lake Arrowhead, CA 92352

Phone: 909-336-1511 | Fax: 909-744-3088



Ming Hsieh Department of  
 Electrical Engineering Retreat  
*sponsored by the Ming Hsieh Institute*  
 March 26 -27, 2011  
 Lake Arrowhead Resort & Spa

## SATURDAY, 3/26/2011

*Suggested Activities for families  
(if you choose NOT to attend sessions)*

## SATURDAY, 3/26/2011

### AGENDA

## SUNDAY, 3/27/2011

### AGENDA

- 1:00pm **Guide** Meet at MHI information desk (an MHI representative will be at this desk at all times to answer any questions). A guide will walk guests to the Lake Arrowhead Village (2 blocks)
- 1:30pm **Boat Tour** **Arrowhead Queen Boat Tour** - \$16 per person, \$10 per person if a group of 15 or more attend (children under 3 are free). Experience the beauty and excitement of a narrated tour of Lake Arrowhead aboard the elegant Arrowhead Queen. The splendor and serenity of Lake Arrowhead's lush forest, sparkling water and blue skies glide by, as you sit back and enjoy close-up views of exquisite lakefront homes and learn about the fascinating history of the lake on a 50 minute boat tour of the lake. P: 909-336-6992
- 3:00pm **Village** Lake Arrowhead Village (boutiques, outlets, children playgrounds, art galleries) The village is very close to the resort so guests can spend time there at their leisure and walk back to the hotel at their preference, the hotel offers many amenities as well (*details on back*).



MHI information desk will be set up in the Ballroom Foyer with an MHI representative available to answer any questions.

For photos and videos from the 2011 Ming Hsieh Department of Electrical Engineering Retreat - Please visit:  
[mhi.usc.edu/2011-retreat](http://mhi.usc.edu/2011-retreat)

- 11:30am Buffet lunch - Ballroom Foyer (*seating provided in Acorn Room*)
- 1:00pm **Ballroom** Welcome by the MHI leadership, status report of MHI sponsored activities, and introduction to the program
- 1:30pm Structured Brainstorming Session on **"Current and Future Roles of Electrical Engineering in Human Health and Wellbeing"** moderated by Prof. Leahy. Organizing Faculty: Profs. Molisch, Narayanan, Povinelli
- 2:30pm Coffee break - back of the Ballroom
- 3:00pm Structured Brainstorming Session on **"Computing Beyond Moore's Law"** moderated by Prof. Gupta. Organizing Faculty: Profs. Annavaram, Hashemi, Levi, Pinkston, Zhou
- 4:00pm Coffee break & hotel check-in for remaining guests and Ph.D. students (hotel lobby)
- 4:30pm Structured Brainstorming Session on **"Creating an Intelligent Networked World"** moderated by Prof. Caire. Organizing Faculty: Profs. Brun, Dimakis, Jain, Krishnamachari, Mitra, Psounis, Scholtz, Willner
- 5:30pm Social networking & family time
- 7:30pm **Ballroom** Banquet Dinner featuring the Keynote Talk by **Dr. Robert Lucky, *The Joys and Disappointments of Engineering***
- 9:30pm Musical ensemble by USC faculty and Ph.D. students
- 10:00pm Social networking & family time

- 8:00am Buffet breakfast - Lakeview Terrace Room (*will be served until 10am*)
- 9:00am Social networking & family time
- Ballroom** Group activities will be organized but are not mandatory
- LAKESIDE WALKING TOUR  
Meet in lobby at 9:45am, a hotel guide provides guests a 1 ½ hour walk along the shores of Lake Arrowhead using the private Lake Arrowhead Association's walking path. *Weather permitting, in case of bad weather activities will be indoors - Ballroom*
- 11:30pm Hotel check-out  
Bring luggage to Stars Room (room will be secured)
- 12:30pm Buffet lunch - Lakeview Terrace Room
- 1:30pm Welcome by the EE department chairs, department status report
- 2:00pm **Illustrious Past 5 Decades**
- 2:30pm Roundtable discussion on **"Past 4 Decades of Electrical Engineering at USC"** by Profs. Breuer, Cheng, Golomb, Hellwarth, Lindsey, Mendel, Sawchuk, Scholtz, Steier
- 3:30pm Coffee break
- 4:00pm Roundtable discussion on **"Crystal Ball: USC Electrical Engineering Beyond 2020"** by Profs. Brun, Krishnamachari, Narayanan, Ortega, Psounis, Zhou
- 5:30pm Buses depart resort and return to USC